

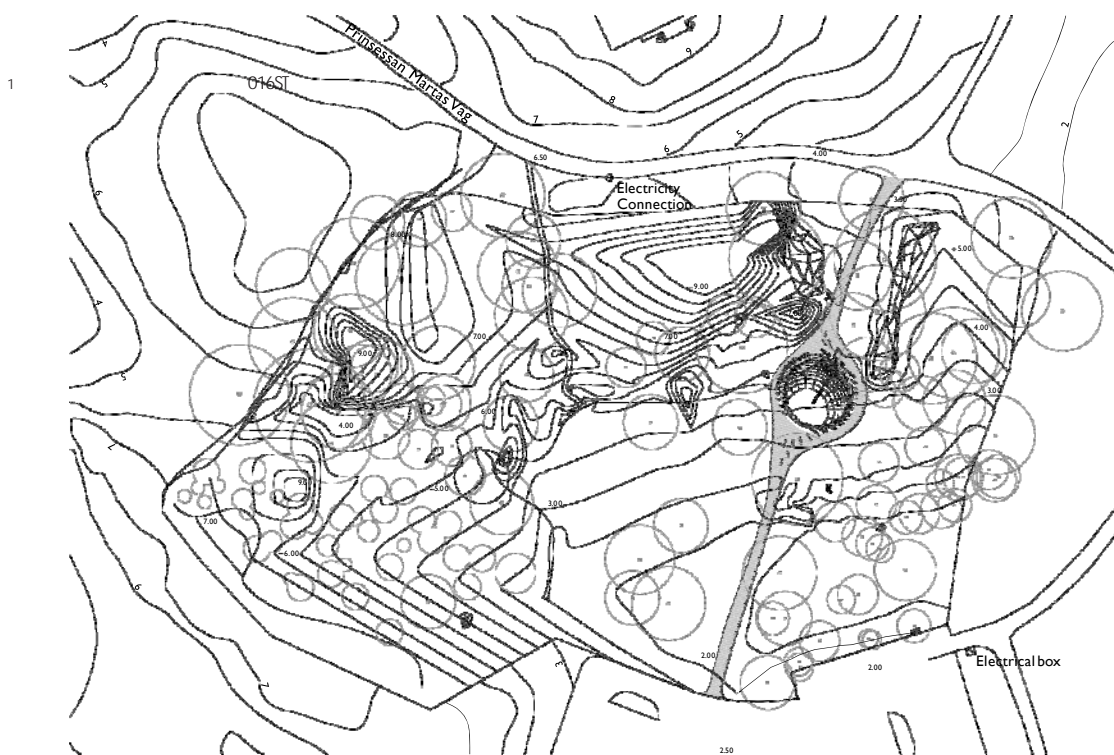

Conceptual diagram

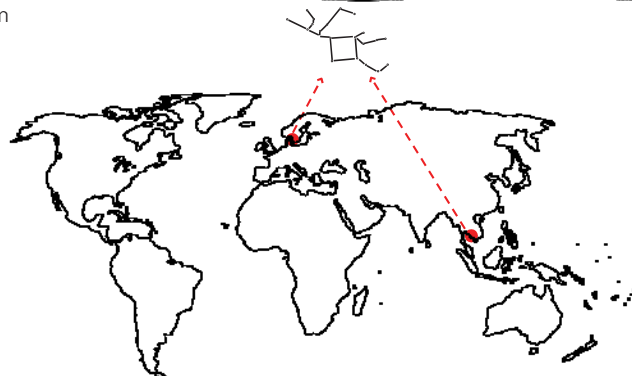

Plan View - 1/400

Proposal for the 2004 South East Asia Tsunami Memorial

The Sundial-conceptual diagram

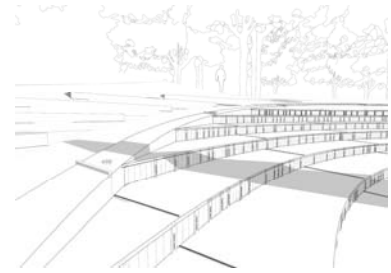
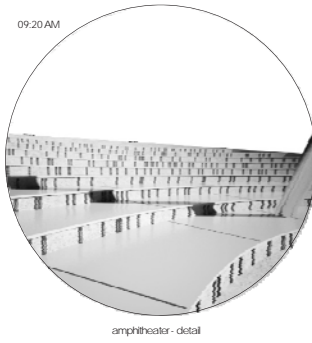
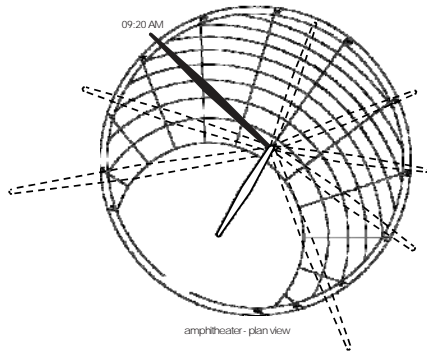

The natural location, its proximity to the water and a relevantly low level of light pollution framed the artistic idea in accordance to its function, delivering a place of social convening, providing a meditative setting where the names of those who passed away in the tragedy are engraved on site, as if asterisms themselves. The proposal for a memorial resembles an amphitheater and recalls the architecture of astronomical observation sites, typical of the Southeast Asia, Janitar Mentari in New Delhi as being one example of this. A gudepost is centrally placed, inclined to point towards the constellation Pegasus, which yearly in December, can be seen both from Southern and Northern Hemispheres, South East Asia and Sweden. In daytime, the gudepost acts as a sundial, its silhouette gently illuminating the names inscribed in the steps. The constellation Pegasus therefore becomes a bridge between two continents as shared sight and monument that invites remembrance to all victims.

